

How do I clean and maintain my densitometer?

There are many types of densitometers available, however, they all have similar things in common, such as calibration procedures, zeroing procedures, bulbs, and apertures. Below are some guidelines to help you maintain this very important instrument in your lab.

- Leave the densitometer on at all times. For example, turn unit on Monday morning and do not turn it off until the end of the day on Friday. Constantly turning it the unit on and off will wear down the electronics and may cause variability in your readings.
- Calibrate the densitometer weekly using the manufacturer's calibration wedge.

If you do not have a calibration wedge, contact the manufacturer of your densitometer model to obtain one.

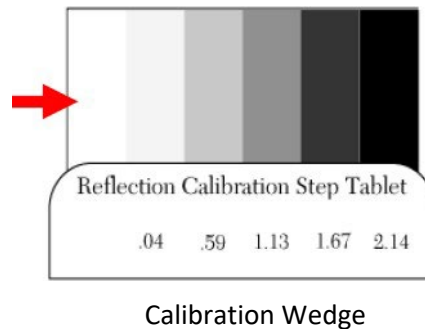

Cleaning the viewing area

To clean the viewing area and change the light bulbs.

1. Remove screws from the viewing area.



Viewing area



Screws

2. Blow out the interior of the white reflector area to clear of dust and debris.

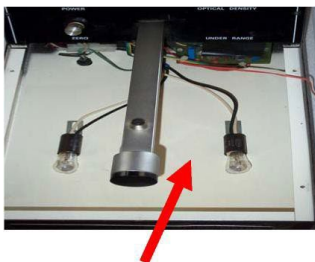

White reflector area



Blow out interior

3. Wipe down the reflector surface area with a dampened lint free cloth.

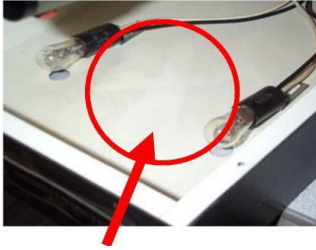

Dirty reflector area



Wipe down with cloth

4. Replace bulbs (if necessary).

5. Replace the viewer and wipe down the area with a dampened lint free cloth.



Replace viewer



Wipe down with cloth

6. Calibrate the machine using the manufacturers calibration wedge.

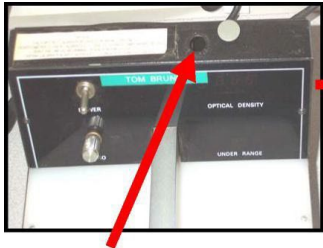

Calibration pod adjuster
(may be located on the rear)

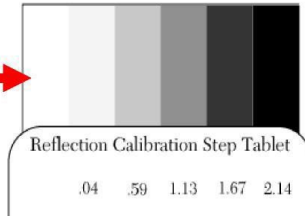

Calibration wedge